

X-STEEL 316

ACCESSORIES
2024

 – newform

CULTURE OF DESIGN

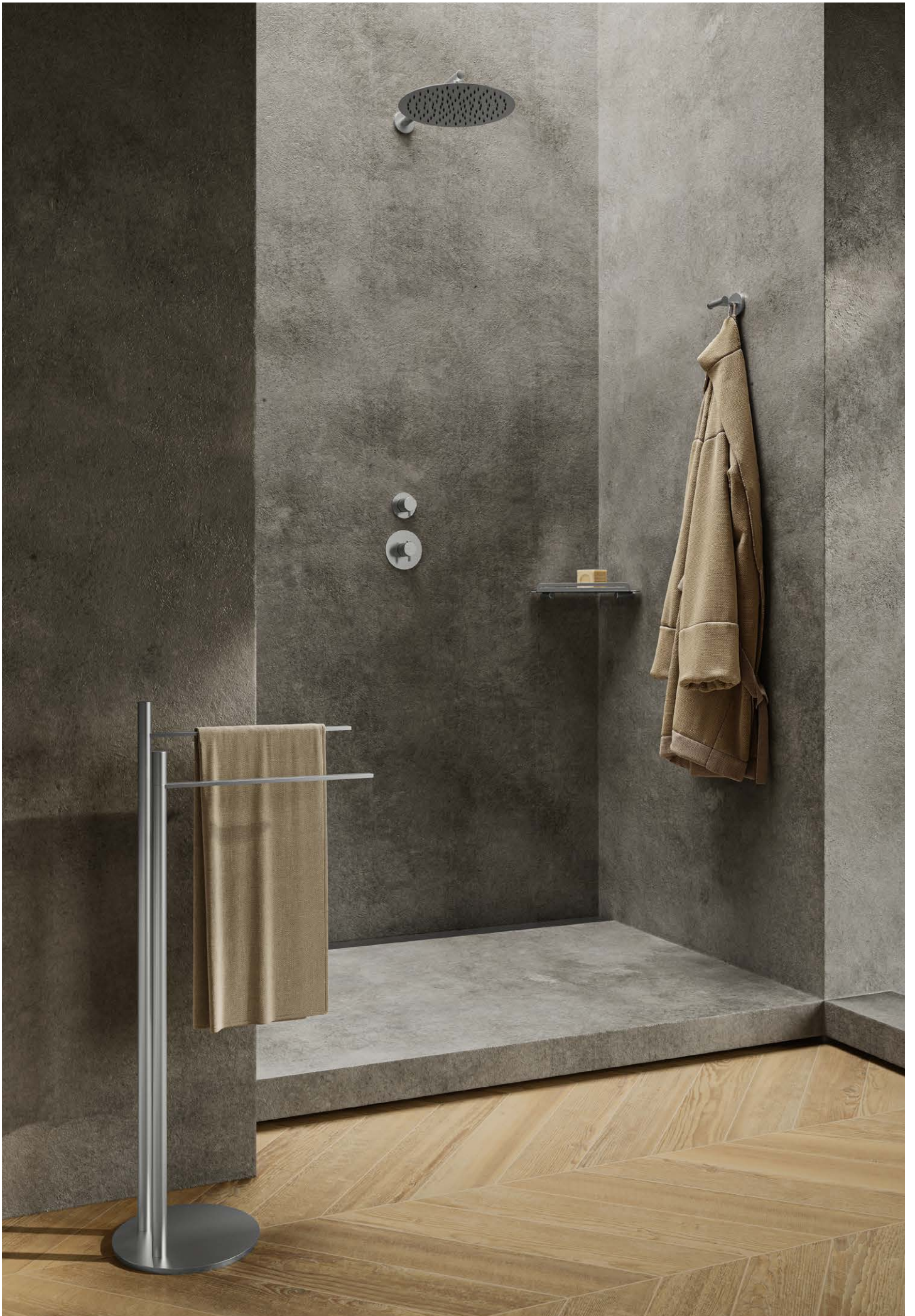



ACCESSORI *ACCESSORIES*

UN DIALOGO APERTO TRA MATERIA ED ESTETICA
AN OPEN DIALOGUE BETWEEN MATERIAL AND AESTHETICS



X-STEEL 316







Focus. *Un nuovo completamento della gamma Newform per l'ambiente bagno diventa innovazione materica al servizio del design.*

Focus. *A new complete range of Newform products for bathroom environments develops into a material innovation at the service of design.*



La nuova gamma di accessori in acciaio inox 316 amplia ufficialmente le potenzialità creative dell'ambiente bagno firmato Newform. All'indiscutibile qualità dell'acciaio si affianca la versatilità delle finiture PVD in versione spazzolata, reminder visivo di un tratto artigianale.

Estensione della collaudata serie X-Steel 316, questo nuovo ventaglio di prodotti è segno di un progetto timeless, eterno, destinato a durare negli anni date le performance qualitative del materiale scelto. All'acciaio si attribuiscono qualità come forte resistenza a corrosioni, igiene, durezza e inossidabilità, con una probabilità pressoché nulla ad arrugginarsi nel tempo. È così che Newform interpreta in chiave contemporanea il prestigio di uno dei materiali a più alta efficienza nel mondo dell'arredo bagno.

Nel trovare il giusto accordo tra estetica ed alte prestazioni, il brand presenta i nuovi accessori X-Steel 316 lasciando un'ulteriore impronta sostenibile tra la gamma di articoli a catalogo: l'acciaio, infatti, è da considerarsi come una "risorsa permanente" sul nostro pianeta, in quanto altamente riciclabile e riutilizzabile più e più volte, evitandone sprechi o dispersioni nell'ambiente.

Scoprire i nuovi accessori X-Steel 316 significa optare per una gamma di complementi d'arredo tradizionali e immancabili nell'ambiente bagno, ma capace di grandi slanci decorativi.

The new range of stainless-steel accessories officially boosts the creative potentialities of the bath environments by Newform. The versatility of PVD brushed finishes joins the indisputable qualities of stainless steel, creating a visual reminder of handcrafted features.

Born as an extension of the well-proven X-Steel 316 series, this new range of products represents a timeless project, designed to last over the years given the qualitative performance of the material chosen. High corrosion resistance, hygiene, durability, as well as a very low probability to rust are the main qualities attributed to stainless steel. Newform therefore presents its modern interpretation of one of the materials with the highest efficiency in the bathroom furnishing.

While looking for the right agreement between aesthetics and high performance, the brand presents the new X-Steel 316 accessories leaving another sustainable mark among the catalogue items: stainless steel must be considered as a "permanent resource" in our planet, since it is highly recyclable and re-usable over and over, avoiding wastes or dispersion in the environment.

Discovering the new X-Steel 316 accessories means opting for a range of traditional and must-have furnishings with a great decorative impulse.







PRODUCTS
SELECTION

ACCIAIO INOX / RESINA
STAINLESS STEEL / RESIN

73200X white resin - **73201X** black resin

Porta sapone a muro.

Wall-mounted soap dish.



● 50.050	Acciaio Inox / Stainless Steel	224,00
● 59.064	PVD Brushed gun metal	268,00
● 59.067	PVD Brushed copper bronze	268,00
● 59.097	PVD Brushed gold	268,00
● 59.098	PVD Brushed pale gold	268,00

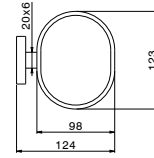
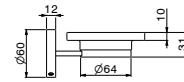

73205X white resin - **73206X** black resin

Porta bicchiere a muro.

Wall-mounted tumbler holder.



● 50.050	Acciaio Inox / Stainless Steel	214,00
● 59.064	PVD Brushed gun metal	259,00
● 59.067	PVD Brushed copper bronze	259,00
● 59.097	PVD Brushed gold	259,00
● 59.098	PVD Brushed pale gold	259,00

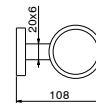
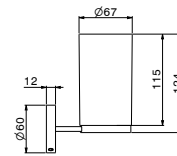

73210X white resin - **73211X** black resin

Dosa sapone a muro.

Wall-mounted soap dispenser.



● 50.050	Acciaio Inox / Stainless Steel	322,00
● 59.064	PVD Brushed gun metal	399,00
● 59.067	PVD Brushed copper bronze	399,00
● 59.097	PVD Brushed gold	399,00
● 59.098	PVD Brushed pale gold	399,00

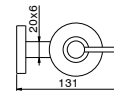
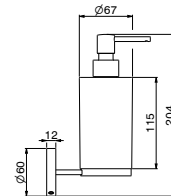

73215X white resin - **73216X** black resin

Porta scopino a muro con scopino.

Wall-mounted toilet brush holder with brush.



● 50.050	Acciaio Inox / Stainless Steel	326,00
● 59.064	PVD Brushed gun metal	412,00
● 59.067	PVD Brushed copper bronze	412,00
● 59.097	PVD Brushed gold	412,00
● 59.098	PVD Brushed pale gold	412,00

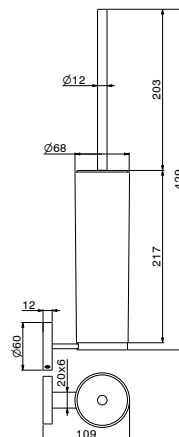

73223X

Porta rotolo a muro versione destra.
Right-side wall-mounted paper holder.



● 50.050	Acciaio Inox / Stainless Steel	232,00
● 59.064	PVD Brushed gun metal	297,00
● 59.067	PVD Brushed copper bronze	297,00
● 59.097	PVD Brushed gold	297,00
● 59.098	PVD Brushed pale gold	297,00

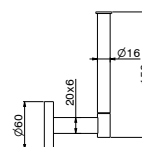
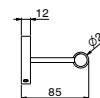

73232X

Porta rotolo a muro versione sinistra.
Left-side wall-mounted paper holder.



● 50.050	Acciaio Inox / Stainless Steel	232,00
● 59.064	PVD Brushed gun metal	297,00
● 59.067	PVD Brushed copper bronze	297,00
● 59.097	PVD Brushed gold	297,00
● 59.098	PVD Brushed pale gold	297,00

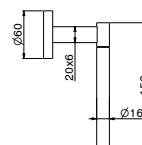
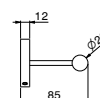

73224X

Porta rotolo a muro versione destra con coperchio.
Right-side wall-mounted paper holder with cover.



● 50.050	Acciaio Inox / Stainless Steel	381,00
● 59.064	PVD Brushed gun metal	538,00
● 59.067	PVD Brushed copper bronze	538,00
● 59.097	PVD Brushed gold	538,00
● 59.098	PVD Brushed pale gold	538,00

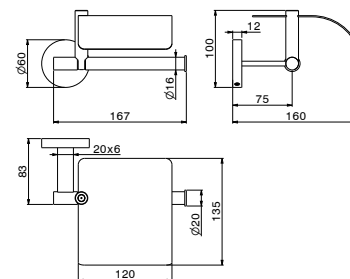

73227X

Porta salvietta corto, 30 cm.
Short towel rail, 30 cm.



● 50.050	Acciaio Inox / Stainless Steel	389,00
● 59.064	PVD Brushed gun metal	520,00
● 59.067	PVD Brushed copper bronze	520,00
● 59.097	PVD Brushed gold	520,00
● 59.098	PVD Brushed pale gold	520,00

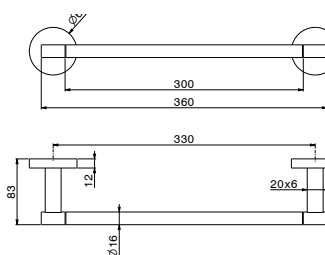

73228X

Porta salvietta medio, 45 cm.
Medium towel rail, 45 cm.



● 50.050	Acciaio Inox / Stainless Steel	402,00
● 59.064	PVD Brushed gun metal	560,00
● 59.067	PVD Brushed copper bronze	560,00
● 59.097	PVD Brushed gold	560,00
● 59.098	PVD Brushed pale gold	560,00

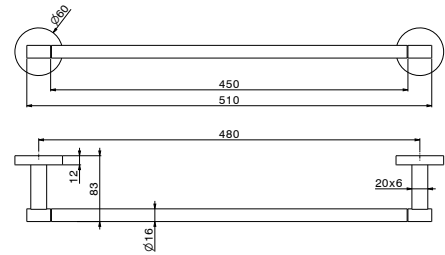

73229X

Porta salvietta lungo, 60 cm.
Long towel rail, 60 cm.



● 50.050	Acciaio Inox / Stainless Steel	417,00
● 59.064	PVD Brushed gun metal	603,00
● 59.067	PVD Brushed copper bronze	603,00
● 59.097	PVD Brushed gold	603,00
● 59.098	PVD Brushed pale gold	603,00

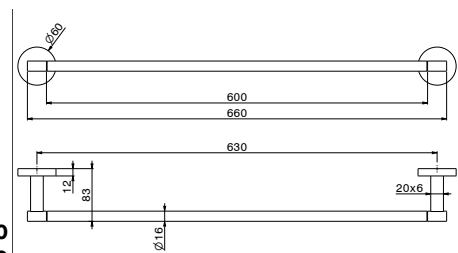

73221X

Appendino a muro.
Robe hook.



● 50.050	Acciaio Inox / Stainless Steel	177,00
● 59.064	PVD Brushed gun metal	228,00
● 59.067	PVD Brushed copper bronze	228,00
● 59.097	PVD Brushed gold	228,00
● 59.098	PVD Brushed pale gold	228,00

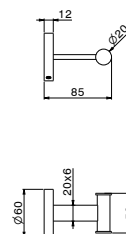

73250X white resin - 73251X black resin

Porta sapone da appoggio.
Freestanding soap dish.



● 50.050	Acciaio Inox / Stainless Steel	111,00
● 59.064	PVD Brushed gun metal	127,00
● 59.067	PVD Brushed copper bronze	127,00
● 59.097	PVD Brushed gold	127,00
● 59.098	PVD Brushed pale gold	127,00

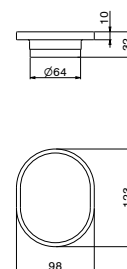

73255X white resin - 73256X black resin

Bicchieri da appoggio.

Freestanding tumbler.

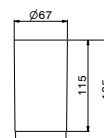

● 50.050	Acciaio Inox / Stainless Steel	109,00
● 59.064	PVD Brushed gun metal	125,00
● 59.067	PVD Brushed copper bronze	125,00
● 59.097	PVD Brushed gold	125,00
● 59.098	PVD Brushed pale gold	125,00

73260X white resin - 73261X black resin

Dosa sapone da appoggio.

Freestanding soap dispenser.

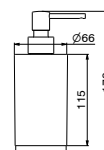

● 50.050	Acciaio Inox / Stainless Steel	218,00
● 59.064	PVD Brushed gun metal	266,00
● 59.067	PVD Brushed copper bronze	266,00
● 59.097	PVD Brushed gold	266,00
● 59.098	PVD Brushed pale gold	266,00



73265X white resin - 73266X black resin

Porta scopino da appoggio con scopino.

Freestanding toilet brush holder with brush.

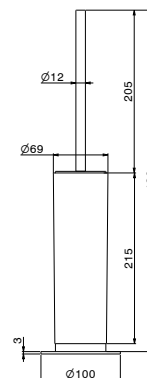

● 50.050	Acciaio Inox / Stainless Steel	280,00
● 59.064	PVD Brushed gun metal	371,00
● 59.067	PVD Brushed copper bronze	371,00
● 59.097	PVD Brushed gold	371,00
● 59.098	PVD Brushed pale gold	371,00

73270X

Piantana porta salviette.

Freestanding towel holder.

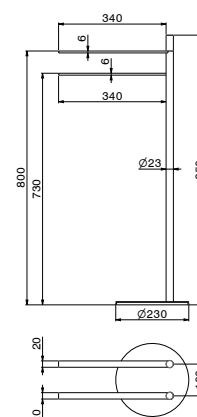

● 50.050	Acciaio Inox / Stainless Steel	740,00
● 59.064	PVD Brushed gun metal	1.434,00
● 59.067	PVD Brushed copper bronze	1.434,00
● 59.097	PVD Brushed gold	1.434,00
● 59.098	PVD Brushed pale gold	1.434,00

73238X

Mensola doccia angolare a muro.
Wall mounted corner shower shelf.



● 50.050	Acciaio Inox / Stainless Steel	332,00
● 59.064	PVD Brushed gun metal	564,00
● 59.067	PVD Brushed copper bronze	564,00
● 59.097	PVD Brushed gold	564,00
● 59.098	PVD Brushed pale gold	564,00

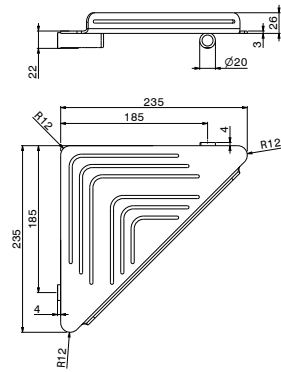

73244X

Mensola vasca/doccia rettangolare a muro.
Wall mounted rectangular bath/shower shelf.



● 50.050	Acciaio Inox / Stainless Steel	312,00
● 59.064	PVD Brushed gun metal	442,00
● 59.067	PVD Brushed copper bronze	442,00
● 59.097	PVD Brushed gold	442,00
● 59.098	PVD Brushed pale gold	442,00

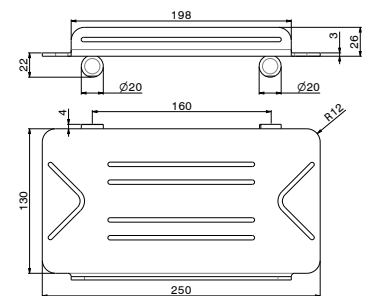

ACCIAIO INOX / RESINA - STAINLESS STEEL / RESIN

RICAMBI / SPARE PARTS

32668 white resin - **32669** black resin

Ricambio porta sapone per versione a parete.

Soap dish replacement, wall-mounted version.



00.000 Neutro / Neutral **72,00**

32676X

Ricambio dosa sapone.

Soap dispenser replacement.



● 50.050 Acciaio Inox / Stainless Steel	132,00
● 59.064 PVD Brushed gun metal	164,00
● 59.067 PVD Brushed copper bronze	164,00
● 59.097 PVD Brushed gold	164,00
● 59.098 PVD Brushed pale gold	164,00

32672 white resin - **32673** black resin

Ricambio porta sapone per versione da appoggio.

Soap dish replacement, freestanding version.



00.000 Neutro / Neutral **63,00**

32670 white resin - **32671** black resin

Ricambio per porta scopino a parete e da appoggio.

Replacement for wall-mounted toilet brush holder.



00.000 Neutro / Neutral **98,00**

32664 white resin - **32665** black resin

Ricambio bicchiere per versione a parete e da appoggio.

Replacement tumbler, wall-mounted and freestanding version.



00.000 Neutro / Neutral **60,00**

11467

Ciuffo per scopino.

Brush replacement.



00.000 Neutro / Neutral **29,00**

32666 white resin - **32667** black resin

Ricambio bicchiere per dosa sapone a parete e da appoggio.

Replacement tumbler for soap dispenser.



00.000 Neutro / Neutral **72,00**

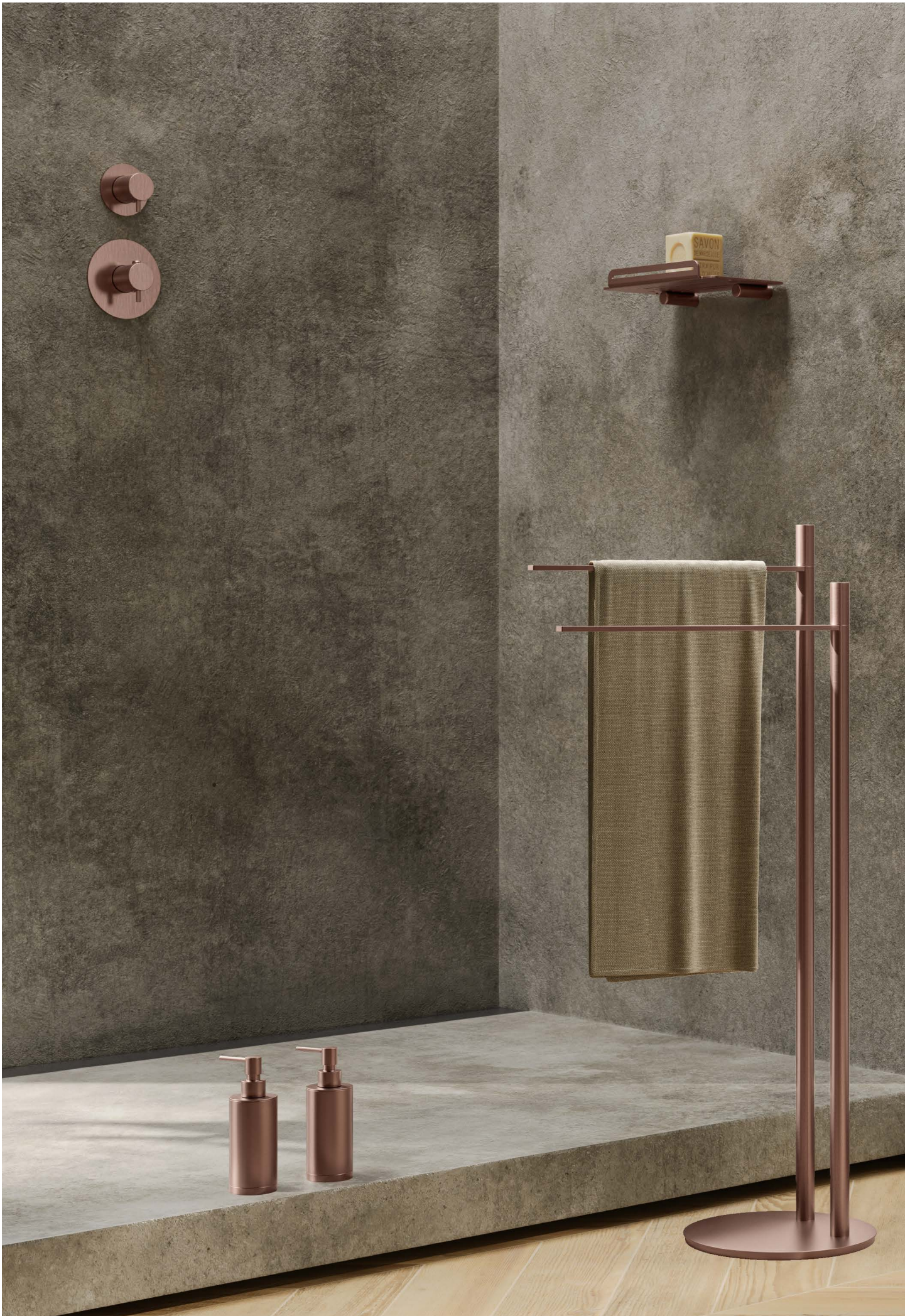

PRODUCTS
SELECTION

ACCIAIO INOX / STAINLESS STEEL

ACCIAIO INOX - STAINLESS STEEL

73204X

Porta bicchiere a muro.

Wall-mounted tumbler holder.



●	50.050 Acciaio Inox / Stainless Steel	251,00
●	59.064 PVD Brushed gun metal	339,00
●	59.067 PVD Brushed copper bronze	339,00
●	59.097 PVD Brushed gold	339,00
●	59.098 PVD Brushed pale gold	339,00

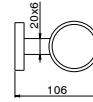
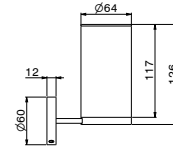

73209X

Dosa sapone a muro.

Wall-mounted soap dispenser.



●	50.050 Acciaio Inox / Stainless Steel	372,00
●	59.064 PVD Brushed gun metal	500,00
●	59.067 PVD Brushed copper bronze	500,00
●	59.097 PVD Brushed gold	500,00
●	59.098 PVD Brushed pale gold	500,00

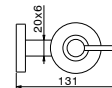
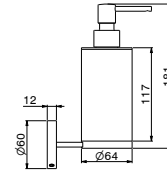

73214X

Porta scopino a muro con scopino.

Wall-mounted toilet brush holder with brush.



●	50.050 Acciaio Inox / Stainless Steel	358,00
●	59.064 PVD Brushed gun metal	483,00
●	59.067 PVD Brushed copper bronze	483,00
●	59.097 PVD Brushed gold	483,00
●	59.098 PVD Brushed pale gold	483,00

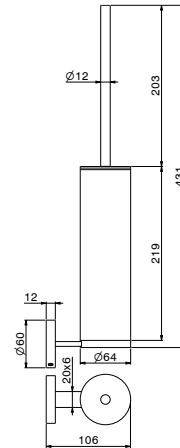

73223X

Porta rotolo a muro versione destra.

Right-side wall-mounted paper holder.



●	50.050 Acciaio Inox / Stainless Steel	232,00
●	59.064 PVD Brushed gun metal	297,00
●	59.067 PVD Brushed copper bronze	297,00
●	59.097 PVD Brushed gold	297,00
●	59.098 PVD Brushed pale gold	297,00

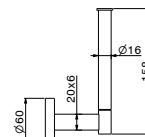
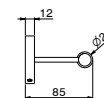

ACCIAIO INOX - STAINLESS STEEL

73232X

Porta rotolo a muro versione sinistra.
Left-side wall-mounted paper holder.

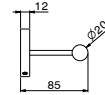

● 50.050	Acciaio Inox / Stainless Steel	232,00
● 59.064	PVD Brushed gun metal	297,00
● 59.067	PVD Brushed copper bronze	297,00
● 59.097	PVD Brushed gold	297,00
● 59.098	PVD Brushed pale gold	297,00



73224X

Porta rotolo a muro versione destra con coperchio.
Right-side wall-mounted paper holder with cover.

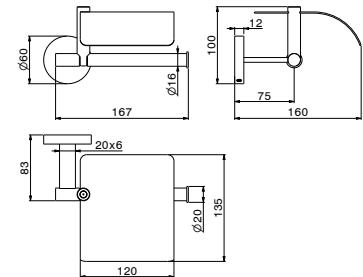

● 50.050	Acciaio Inox / Stainless Steel	381,00
● 59.064	PVD Brushed gun metal	538,00
● 59.067	PVD Brushed copper bronze	538,00
● 59.097	PVD Brushed gold	538,00
● 59.098	PVD Brushed pale gold	538,00

73227X

Porta salvietta corto, 30 cm.
Short towel rail, 30 cm.

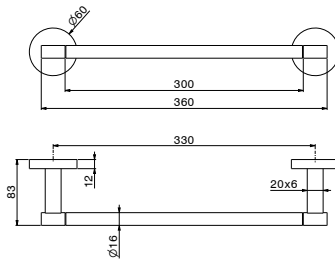

● 50.050	Acciaio Inox / Stainless Steel	389,00
● 59.064	PVD Brushed gun metal	520,00
● 59.067	PVD Brushed copper bronze	520,00
● 59.097	PVD Brushed gold	520,00
● 59.098	PVD Brushed pale gold	520,00

73228X

Porta salvietta medio, 45 cm.
Medium towel rail, 45 cm.

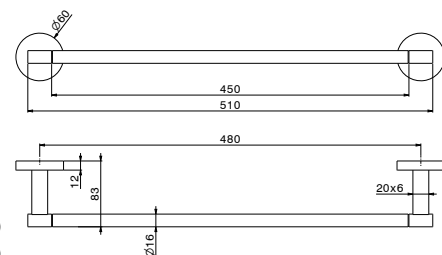

● 50.050	Acciaio Inox / Stainless Steel	402,00
● 59.064	PVD Brushed gun metal	560,00
● 59.067	PVD Brushed copper bronze	560,00
● 59.097	PVD Brushed gold	560,00
● 59.098	PVD Brushed pale gold	560,00

ACCIAIO INOX - STAINLESS STEEL

73229X

Porta salvietta lungo, 60 cm.

Long towel rail, 60 cm.



● 50.050	Acciaio Inox / Stainless Steel	417,00
● 59.064	PVD Brushed gun metal	603,00
● 59.067	PVD Brushed copper bronze	603,00
● 59.097	PVD Brushed gold	603,00
● 59.098	PVD Brushed pale gold	603,00

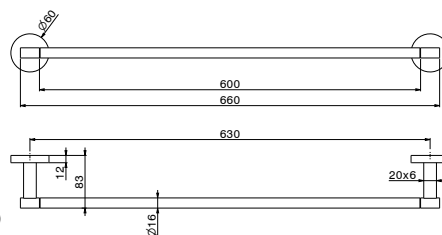

73221X

Appendino a muro.

Robe hook.



● 50.050	Acciaio Inox / Stainless Steel	177,00
● 59.064	PVD Brushed gun metal	228,00
● 59.067	PVD Brushed copper bronze	228,00
● 59.097	PVD Brushed gold	228,00
● 59.098	PVD Brushed pale gold	228,00

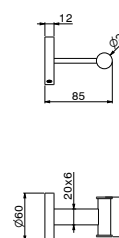

73254X

Bicchieri da appoggio.

Freestanding tumbler.



● 50.050	Acciaio Inox / Stainless Steel	146,00
● 59.064	PVD Brushed gun metal	211,00
● 59.067	PVD Brushed copper bronze	211,00
● 59.097	PVD Brushed gold	211,00
● 59.098	PVD Brushed pale gold	211,00

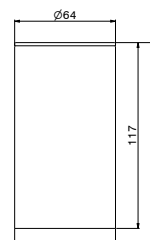

73259X

Dosa sapone da appoggio.

Freestanding soap dispenser.



● 50.050	Acciaio Inox / Stainless Steel	270,00
● 59.064	PVD Brushed gun metal	369,00
● 59.067	PVD Brushed copper bronze	369,00
● 59.097	PVD Brushed gold	369,00
● 59.098	PVD Brushed pale gold	369,00

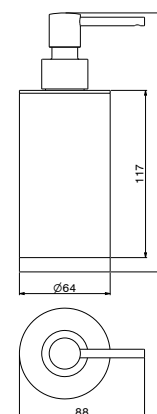

ACCIAIO INOX - STAINLESS STEEL



73264X

Porta scopino da appoggio con scopino.
Freestanding toilet brush holder with brush.

- **50.050** Acciaio Inox / Stainless Steel **317,00**
- **59.064** PVD Brushed gun metal **448,00**
- **59.067** PVD Brushed copper bronze **448,00**
- **59.097** PVD Brushed gold **448,00**
- **59.098** PVD Brushed pale gold **448,00**

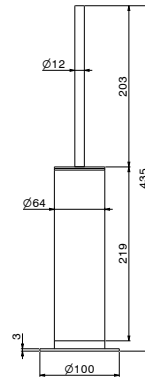

73270X

Piantana porta salviette.
Freestanding towel holder.

- **50.050** Acciaio Inox / Stainless Steel **740,00**
- **59.064** PVD Brushed gun metal **1.434,00**
- **59.067** PVD Brushed copper bronze **1.434,00**
- **59.097** PVD Brushed gold **1.434,00**
- **59.098** PVD Brushed pale gold **1.434,00**

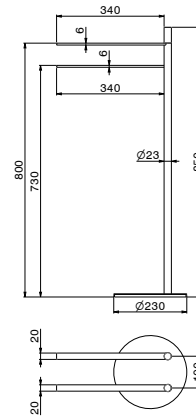

73238X

Mensola doccia angolare a muro.
Wall mounted corner shower shelf.

- **50.050** Acciaio Inox / Stainless Steel **332,00**
- **59.064** PVD Brushed gun metal **564,00**
- **59.067** PVD Brushed copper bronze **564,00**
- **59.097** PVD Brushed gold **564,00**
- **59.098** PVD Brushed pale gold **564,00**

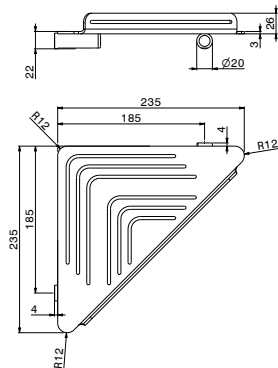

73244X

Mensola vasca/doccia rettangolare a muro.
Wall mounted rectangular bath/shower shelf.

- **50.050** Acciaio Inox / Stainless Steel **312,00**
- **59.064** PVD Brushed gun metal **442,00**
- **59.067** PVD Brushed copper bronze **442,00**
- **59.097** PVD Brushed gold **442,00**
- **59.098** PVD Brushed pale gold **442,00**

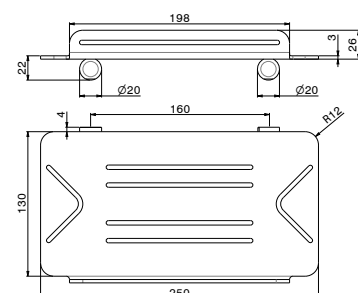

ACCIAIO INOX – STAINLESS STEEL

32637



Ricambio parte interna in polipropilene per bicchiere.

Polypropylene spare part for tumbler's inner component.

00.000 Neutro / Neutral **29,00**

32678X



Ricambio per porta scopino a parete e da appoggio.

Replacement for wall-mounted toilet brush holder.

● 50.050	Acciaio Inox / Stainless Steel	122,00
● 59.064	PVD Brushed gun metal	163,00
● 59.067	PVD Brushed copper bronze	163,00
● 59.097	PVD Brushed gold	163,00
● 59.098	PVD Brushed pale gold	163,00

32675X



Ricambio bicchiere per versione a parete e da appoggio.

Replacement tumbler, wall-mounted and freestanding version.

● 50.050	Acciaio Inox / Stainless Steel	100,00
● 59.064	PVD Brushed gun metal	134,00
● 59.067	PVD Brushed copper bronze	134,00
● 59.097	PVD Brushed gold	134,00
● 59.098	PVD Brushed pale gold	134,00

32638



Ricambio parte interna in polipropilene per portascopino.

Polypropylene spare part for the inner component of the toilet brush holder.

00.000 Neutro / Neutral **36,00**

32677X



Ricambio bicchiere per dosa sapone a parete e da appoggio.

Replacement tumbler for soap dispenser.

● 50.050	Acciaio Inox / Stainless Steel	158,00
● 59.064	PVD Brushed gun metal	211,00
● 59.067	PVD Brushed copper bronze	211,00
● 59.097	PVD Brushed gold	211,00
● 59.098	PVD Brushed pale gold	211,00

11467



Ciuffo per scopino.

Brush replacement.

00.000 Neutro / Neutral **29,00**

32676X



Ricambio dosa sapone.

Soap dispenser replacement.

● 50.050	Acciaio Inox / Stainless Steel	132,00
● 59.064	PVD Brushed gun metal	164,00
● 59.067	PVD Brushed copper bronze	164,00
● 59.097	PVD Brushed gold	164,00
● 59.098	PVD Brushed pale gold	164,00

X-STEEL 316

ACCESSORI ACCESSORIES

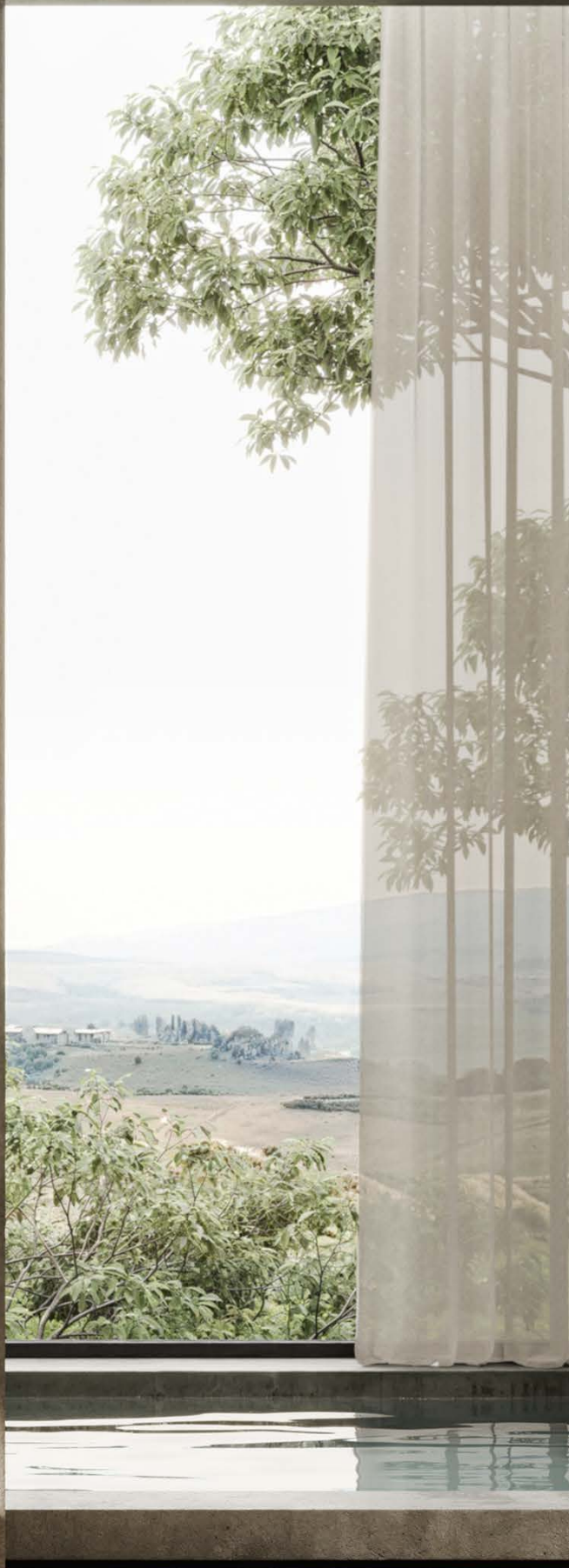

50.050

Acciaio inox / *Stainless steel*



59.064

PVD Brushed gun metal



59.067

PVD Brushed copper bronze



59.097

PVD Brushed gold



59.098

PVD Brushed pale gold

CONDIZIONI GENERALI DI VENDITA

1. Con la trasmissione dell'ordine il Cliente accetta tacitamente tutte le condizioni sottoesposte. Le vendite si intendono perfezionate solo dopo espressa approvazione della nostra azienda.
2. La merce è venduta al prezzo in vigore alla data della consegna. I termini di consegna si intendono approssimativi e quindi non impegnativi e non danno diritto alcuno a mancato pagamento o richiesta di risarcimento.
3. La merce viaggia a rischio e pericolo del committente anche se venduta a franco destino. La spedizione viene effettuata nel modo ritenuto più idoneo dalla ditta venditrice. All'atto della consegna il committente è tenuto alla verifica del materiale ordinato nonché al reclamo diretto al vettore in caso di manomissione o danneggiamento dell'imballo.
4. È fatta riserva assoluta di rendere del materiale senza nostra preventiva autorizzazione scritta.
5. Ogni reclamo e contestazione dovrà essere comunicato a mezzo lettera raccomandata entro e non oltre 5 giorni dalla data di ricevimento. In caso di reclamo effettuato in tempo utile, la merce dovrà esserci inviata franco nostro magazzino previo verifica dell'eventuale difetto. Nel caso di materiale riscontrato difettoso per cause a noi imputabili si provvederà alla sostituzione del prodotto restituito esclusa ogni ulteriore responsabilità della ditta venditrice per tutte le conseguenze dirette e indirette derivanti dalla installazione e dall'impiego.
6. In caso di ritardato pagamento verranno addebitati gli interessi commerciali a decorrere dal giorno successivo alla scadenza senza ausilio di diffide.
7. Le installazioni e le descrizioni contenute nei nostri stampati non comportano obbligo di fedele esecuzione, i dettagli e le misure contenute sono da considerarsi approssimative e soggette a modifiche senza preavviso.
8. In qualsiasi controversia la competenza esclusiva sarà del Foro di Vercelli.

Newform si riserva il diritto di apportare in qualunque momento, senza aggiornare tempestivamente questa pubblicazione, tutte quelle modifiche ai modelli, a scopo di miglioramento o per esigenze di carattere costruttivo.

Eventuali errori e/o refusi di stampa del presente listino non costituiscono motivo di contestazione.

RUBINETTERIA COLORATA

Per evitare errori o ritardi di spedizione, negli ordini specificare sempre il "numero di riferimento" corrispondente al colore prescelto sul n/s campionario colori.

Per colori e finiture NON DI SERIE, Newform si riserva di:

- Verificare la fattibilità.
- Comunicare eventuali costi aggiuntivi.
- Stabilire adeguati tempi di consegna.

PREZZI

Tutti i prezzi indicati si intendono in euro al netto di I.V.A. Il presente listino annulla e sostituisce tutti i precedenti.

GENERAL CONDITIONS OF SALE

1. *The buyer, by placing a purchase order, unconditionally accepts all the conditions below. Sales are considered confirmed only after the express approval of our company.*
2. *Products are sold at the price applicable at the date of delivery. Terms of delivery are approximative and not binding and will not entitle the Buyer to claim compensation for any damages or indemnities of any kind.*
3. *The goods travel at risk and expense of the Buyer even if Delivered Duty Paid. The selling company chooses the most suitable shipment method. The Buyer must check at the time of the delivery and detect any discrepancies related to the packaging, quantity, type and integrity of the Products with notification to the carrier.*
4. *It is not allowed to return products without our prior written authorization.*
5. *Any complaint and dispute must be communicated by registered letter within 5 days from the receipt. In the event of a complaint made in due time, Products must be immediately sent to our warehouse to allow the completion of the necessary tests. In case of defective products due to production problems, the defective product will be replaced, excluding any further liability for damages and/or defects of the Products deriving from anomalies caused by, or connected to, the installation by the Buyer or by the final consumer.*
6. *In case of late payment, interest rates will be charged starting from the day following the deadline without any notice.*
7. *The installations and descriptions in our documents do not imply an obligation of faithful execution, the details, and measures here are to be considered approximate and subject to change without notice.*
8. *Any dispute related to the Products supplied to the Buyer shall be decided by the Court of Vercelli.*

Newform reserves the right to modify all models for the purpose of improving them or for manufacturing needs, without prior notice to this publication and at any time.

Possible mistakes and/or misprints of current price list will not be object of dispute.

COLOURED ITEMS

In order to avoid mistakes or delays in shipping please always specify the reference number related to your choice based our colour table.

For DIFFERENT colours and finishings, Newform reserves the possibility:

- *To accept the order.*
- *To review the price.*
- *To adjust delivery time.*

PRICES

All prices do not include VAT. The present price list cancels and replaces all previous ones.

SISTEMA DI QUALITÀ CERTIFICATO CERTIFIED QUALITY SYSTEM

DESIGN MAKES RESPONSIBLE

Lo scopo prioritario di Newform è quello di fornire un prodotto di qualità superiore, progettato minuziosamente e costruito solamente con materiali di prima scelta, una metodologia certificata secondo le norme UNI-EN ISO 9001 per la progettazione e produzione di rubinetteria sanitaria e accessori da bagno. Inoltre, la creazione e l'implementazione di un sistema integrato che permette sistematicamente di migliorare le condizioni lavorative e di ridurre l'impatto ambientale secondo gli standard ISO 45001 ed ISO 14001, è un altro importante passo verso una sempre più consapevole responsabilità sociale d'impresa.

Newform's first priority is to create high quality products, conceived carefully in every single detail and produced only with first quality materials, a method recognised by UNI-EN ISO 9001 standards for design and production of sanitary taps and bathroom accessories. Furthermore, creation and implementation of an integrated system to continuously improve working conditions and reduce environmental impact according to ISO 45001 and ISO 14001 standards is another important step towards Corporate Social Responsibility.





www.newform.it
newform@newform.it

NEWFORM S.p.A.
via Marconi, 25/A
Frazione Vintebbio
13037 Serravalle Sesia (VC) Italy
Phone: +39 0163 452011 (r.a.)

Direzione Creativa / Creative Direction: Newform

I colori rappresentati nelle immagini sono puramente indicativi.

L'azienda si riserva in qualunque momento di apportare senza preavviso modifiche a prodotti e accessori.

Eventuali errori e/o refusi di stampa del presente listino non costituiscono motivo di contestazione.

The colours shown are just an indication.

The Manufacturer reserves the right to modify products and accessories at any time without prior notice.

Possible mistakes and/or misprints of current price list will not be object of dispute.



newform.it